

A night photograph of a town square. In the center is a church with a prominent spire and a dome, illuminated from below. To the right, a modern, curved bridge with a metal railing spans across a river. The lights from the buildings and bridge are reflected in the water. The sky is dark with some stars visible.

perry bower house

An exclusive development of
7 luxury apartments in the
heart of Historic Upton

GUTHRIE **GR** ROBERTS

Modern luxury living with superb views



- Communal gardens with raised beds and seating area
- Private patios for garden apartments 1,3 & 4
- Bespoke interiors for living rooms and bedrooms
- Fitted carpets to bedrooms
- Polished chrome door furniture
- Private front doors for apartments 1,2,3 & 4
- Communal television aerial and satellite dish
- Full Building Regulations certification

- Panoramic views of the Malvern Hills from apartments 6 & 7
- Luxury Karndean flooring to hall, living areas and bathrooms
- Contemporary oak internal doors
- Designated off road car parking space for each apartment
- Door entry system to apartments 5, 6 & 7
- Smoke alarms hardwired to mains supply with battery back up
- Discreet bin and bike store within utility area
- Architect Design and Build Certificate and 10 year warranty

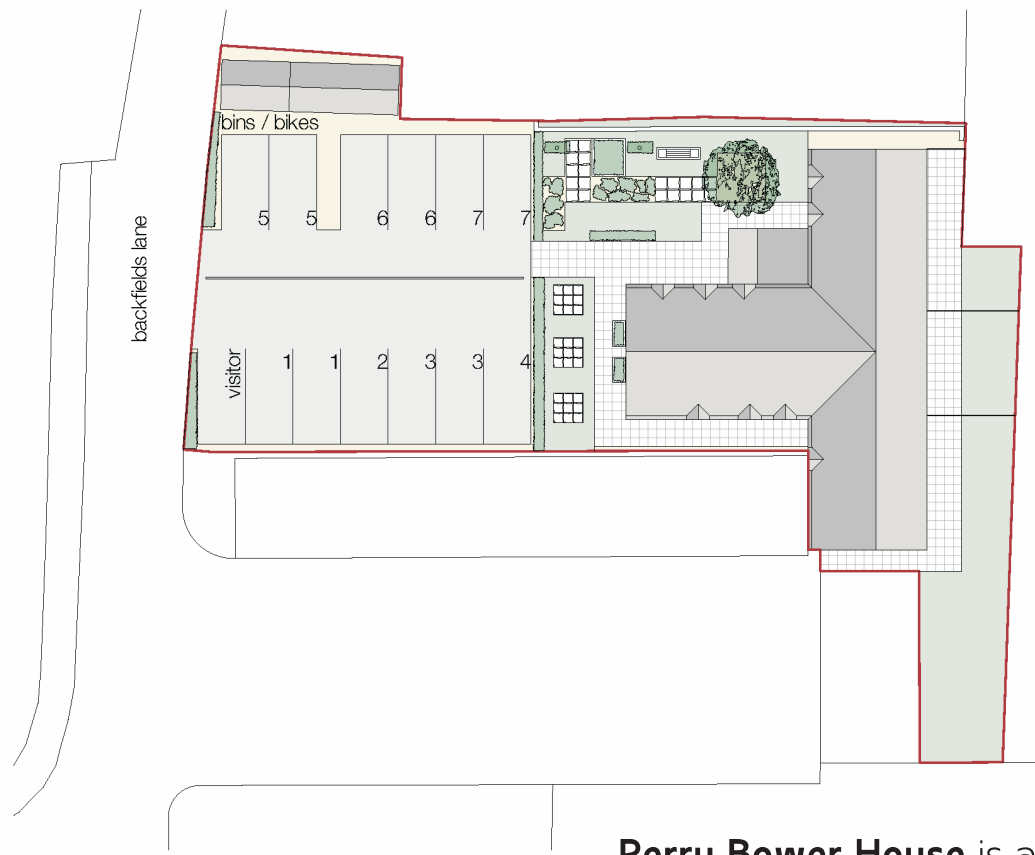

perry  bower
house

Perry Bower House is an exclusive collection of 7 contemporary apartments, located near the centre of **Upton Upon Severn** with good views of the historic **Pepperpot** memorial, and the **Malvern Hills**.

Upton is host to market shops, independent boutiques, restaurants, and riverside pubs, and a range of renowned Jazz and Sunshine Festivals. Schools are also well regarded with Upton Upon Severn C of E Primary School a short walk, and Hanley Castle High School just 5 minutes by car.

Upton has excellent transport links including easy access to the M5 via J8. From 2017 the new Worcester Parkway Station (just a 12 minute drive away) will deliver direct links to Birmingham and Bristol as well as regular trains to London in under 2 hours.

Quiet, central living in a historic riverside setting



GROUND FLOOR



FIRST FLOOR

Luxury Living

- Television (Terrestrial and Sky) points to all living rooms and selected bedrooms
- Telephone lines installed
- Tiled bathrooms
- Back-to-wall WCs and concealed cisterns with chrome dual flush plate
- Contemporary wash basins with Hansgrohe mixer
- Taps, polished chrome heated towel rails
- Recessed top lit mirrors and shaver sockets

Superb Specification

- Individually designed kitchen
- Branded appliances
- Integrated Single Oven, Ceramic Hob and Extractor
- Integrated Dishwasher, Fridge/Freezer, Microwave
- Integrated Bosch Washer Dryer
- Fitted wardrobes
- Feature LED under plinth lighting
- Chrome switches and sockets
- Down lighters on dimmers switches mood lighting in living rooms, kitchens and bathrooms
- Gas fired central heating and hot water with Compact Combi Boilers